

SNAP 2-4

CHANGE OF BLADE HOUSING / CONTROL BOLT

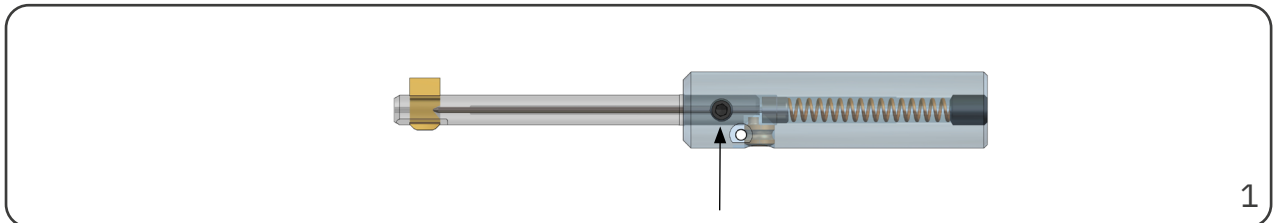

Step 1: Unscrew the clamping screw of the blade housing.

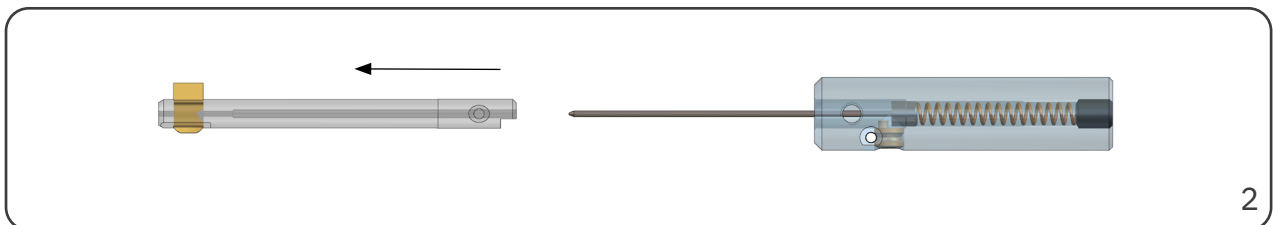

Step 2: Pull the blade housing out of the tool body.

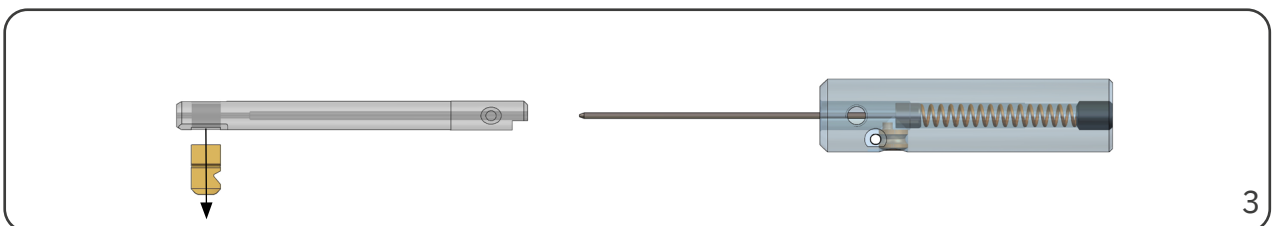

Step 3: Remove the blade out of the blade housing.

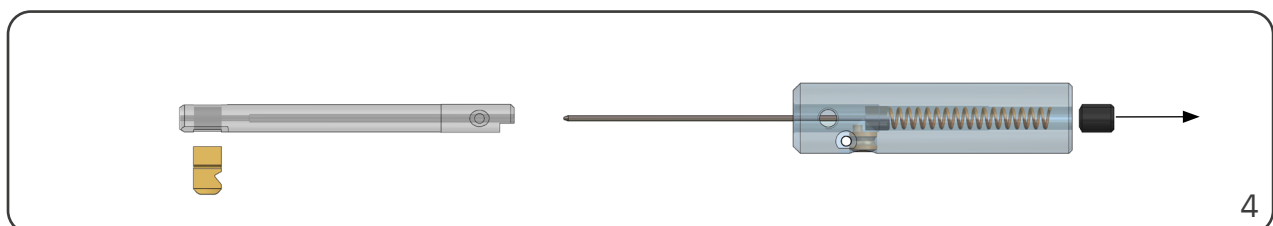

Step 4: Unscrew and remove the set screw.

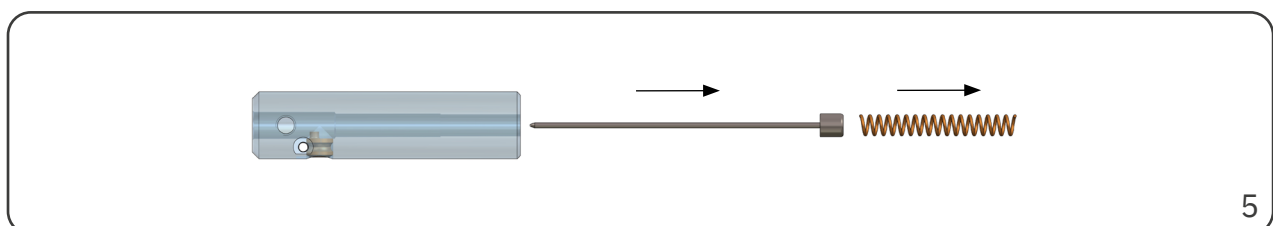

Step 5: Take the spring and the control bolt out of the tool body by pushing the tip of the control bolt towards the tool body.

SNAP 2-4

CHANGE OF BLADE HOUSING / CONTROL BOLT

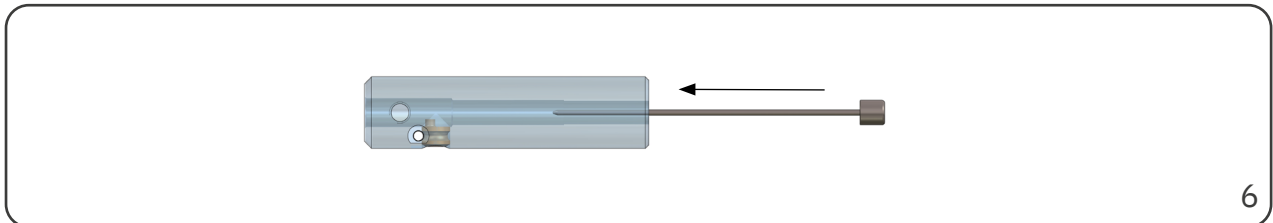

Step 6: Insert the new control bolt into the back of end of the tool body.

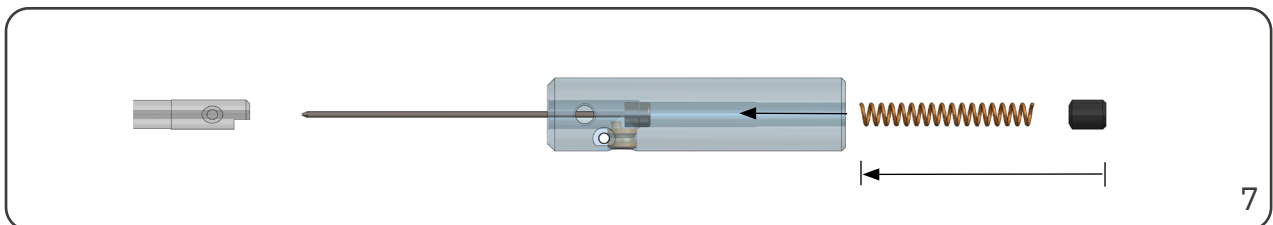

Step 7: Insert the old spring back into the tool body, place the set screw and screw it in until it is flush with the tool body.

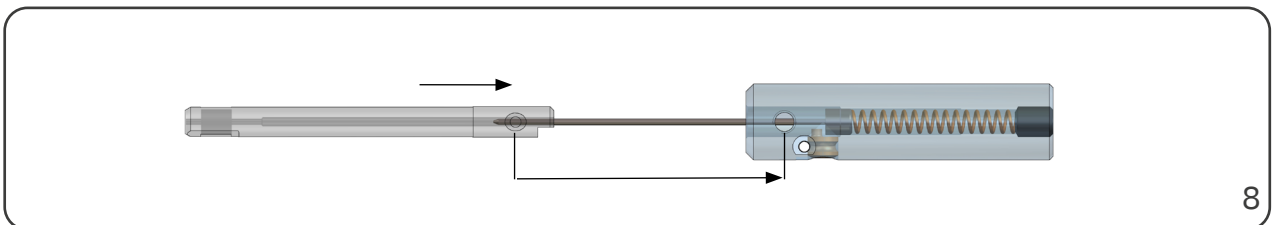

Step 8: Thread the control bolt tip into the new blade housing and slide it into the tool body. Position the fixing recess for the clamping screw precisely under the opening of the hole for the clamping screw. Then insert and tighten the clamping screw, so that it is well beneath the surface level of the tool body.

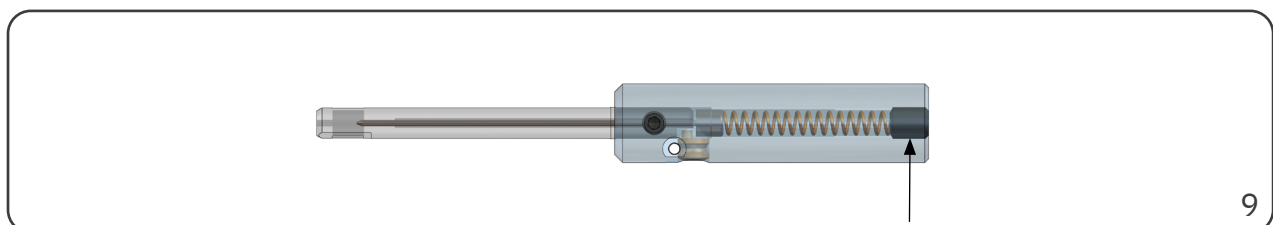

Step 9: Reset the spring tension to its standard value by turning the set screw 4 x 360° clockwise.

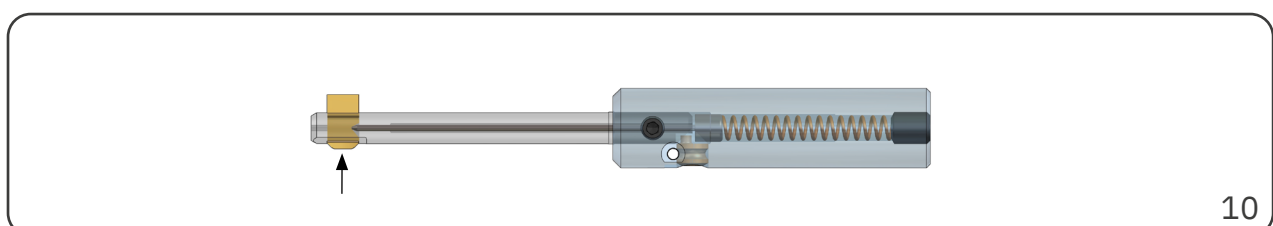

Step 10: to insert the blade, follow the instruction provided by our catalogue or instruction video.