

DL2

BLADE CHANGE

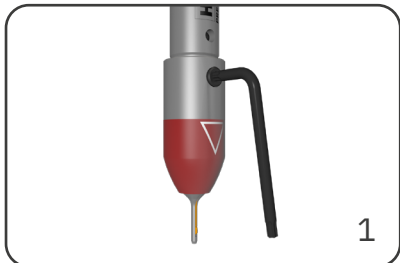

Loosen the clamping screw with the supplied Torx wrench.

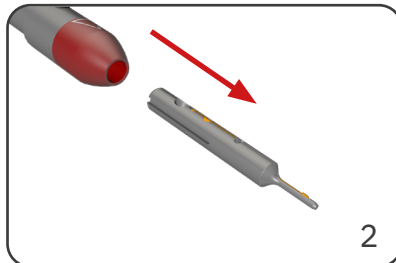

Carefully pull the blade housing out of the main body.

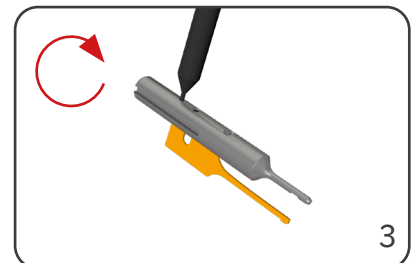

Insert a small pointed instrument through the hole on the underside of the blade housing. This lifts the blade out of its housing enabling easy removal.

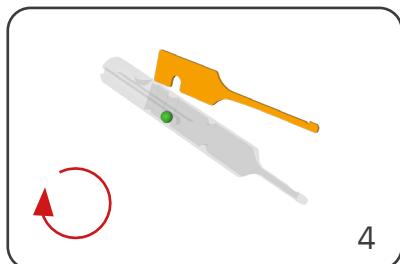

Insert the new blade from above, paying attention to the positioning ball.

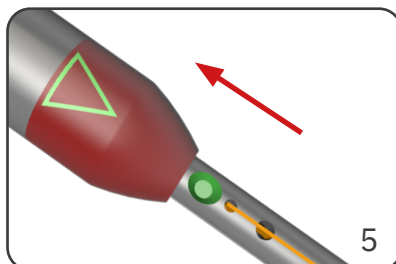

Slide the blade housing back into the tool body. The arrow on the coolant sleeve is aligned with the bore of the clamping screw.

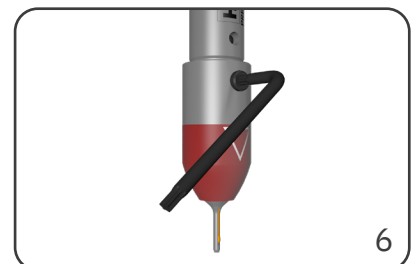

To complete the blade change, tighten the clamping screw using the Torx wrench.